

**PAVING NOTES**

- ALL PAVING SHALL CONFORM TO "STATE OF WISCONSIN STANDARD SPECIFICATIONS FOR HIGHWAY & STRUCTURE CONSTRUCTION AND APPLICABLE CITY OF NEW BERLIN ORDINANCES.
- CONCRETE PAVING SPECIFICATIONS—  
 CODES AND STANDARDS — THE PLACING, CONSTRUCTION AND COMPOSITION OF THE CONCRETE PAVEMENT SHALL BE IN ACCORDANCE WITH THE REQUIREMENTS OF SECTIONS 415 AND 416 OF THE STATE OF WISCONSIN STANDARD SPECIFICATIONS FOR HIGHWAY AND STRUCTURE CONSTRUCTION, CURRENT EDITION. HEREAFTER, THIS PUBLICATION WILL BE REFERRED TO AS STATE HIGHWAY SPECIFICATIONS.  
 CRUSHED AGGREGATE BASE COURSE — THE BASE COURSE SHALL CONFORM TO SECTIONS 301 AND 305, STATE HIGHWAY SPECIFICATIONS. CLEAN RECYCLED CRUSHED CONCRETE MAY BE USE IF APPROVED BY GEOTECH ENGINEER OF RECORD.  
 SURFACE PREPARATION — NOTIFY CONTRACTOR OF UNSATISFACTORY CONDITIONS. DO NOT BEGIN PAVING WORK UNTIL DEFICIENT SUBBASE AREAS HAVE BEEN CORRECTED AND ARE READY TO RECEIVE PAVING.
- ASPHALTIC CONCRETE PAVING SPECIFICATIONS—  
 CODES AND STANDARDS — THE PLACING, CONSTRUCTION AND COMPOSITION OF THE ASPHALTIC BASE COURSE AND ASPHALTIC CONCRETE SURFACING SHALL BE IN ACCORDANCE WITH THE REQUIREMENTS OF SECTIONS 450, 455, 460 AND 465 OF THE STATE OF WISCONSIN STANDARD SPECIFICATIONS FOR HIGHWAY AND STRUCTURE CONSTRUCTION, EDITION OF 2005. HEREAFTER, THIS PUBLICATION WILL BE REFERRED TO AS STATE HIGHWAY SPECIFICATIONS.  
 WEATHER LIMITATIONS — APPLY TACK COATS WHEN AMBIENT TEMPERATURE IS ABOVE 50° F (10° C) AND WHEN TEMPERATURE HAS NOT BEEN BELOW 35° F (1° C) FOR 12 HOURS IMMEDIATELY PRIOR TO APPLICATION. DO NOT APPLY WHEN BASE IS WET OR CONTAINS EXCESS OF MOISTURE. CONSTRUCT ASPHALTIC CONCRETE SURFACE COURSE WHEN ATMOSPHERIC TEMPERATURE IS ABOVE 40° F (4° C) AND WHEN BASE IS DRY AND WHEN WEATHER IS NOT RAINY. BASE COURSE MAY BE PLACED WHEN AIR TEMPERATURE IS ABOVE 30° F (-1° C).  
 GRADE CONTROL — ESTABLISH AND MAINTAIN REQUIRED LINES AND ELEVATIONS FOR EACH COURSE DURING CONSTRUCTION.  
 CRUSHED AGGREGATE BASE COURSE — THE TOP LAYER OF BASE COURSE SHALL CONFORM TO SECTIONS 301 AND 305, STATE HIGHWAY SPECIFICATIONS. CLEAN RECYCLED CRUSHED CONCRETE MAY BE USE IF APPROVED BY GEOTECH ENGINEER OF RECORD.  
 BINDER COURSE AGGREGATE — THE AGGREGATE FOR THE BINDER COURSE SHALL CONFORM TO SECTIONS 460.2.7 AND 315, STATE HIGHWAY SPECIFICATIONS.  
 SURFACE COURSE AGGREGATE — THE AGGREGATE FOR THE SURFACE COURSE SHALL CONFORM TO SECTIONS 460.2.7 AND 465, STATE HIGHWAY SPECIFICATIONS.  
 ASPHALTIC MATERIALS — THE ASPHALTIC MATERIALS SHALL CONFORM TO SECTION 455 AND 460, STATE HIGHWAY SPECIFICATIONS.  
 SURFACE PREPARATION — NOTIFY CONTRACTOR OF UNSATISFACTORY CONDITIONS. DO NOT BEGIN PAVING WORK UNTIL DEFICIENT SUBBASE AREAS HAVE BEEN CORRECTED AND ARE READY TO RECEIVE PAVING.

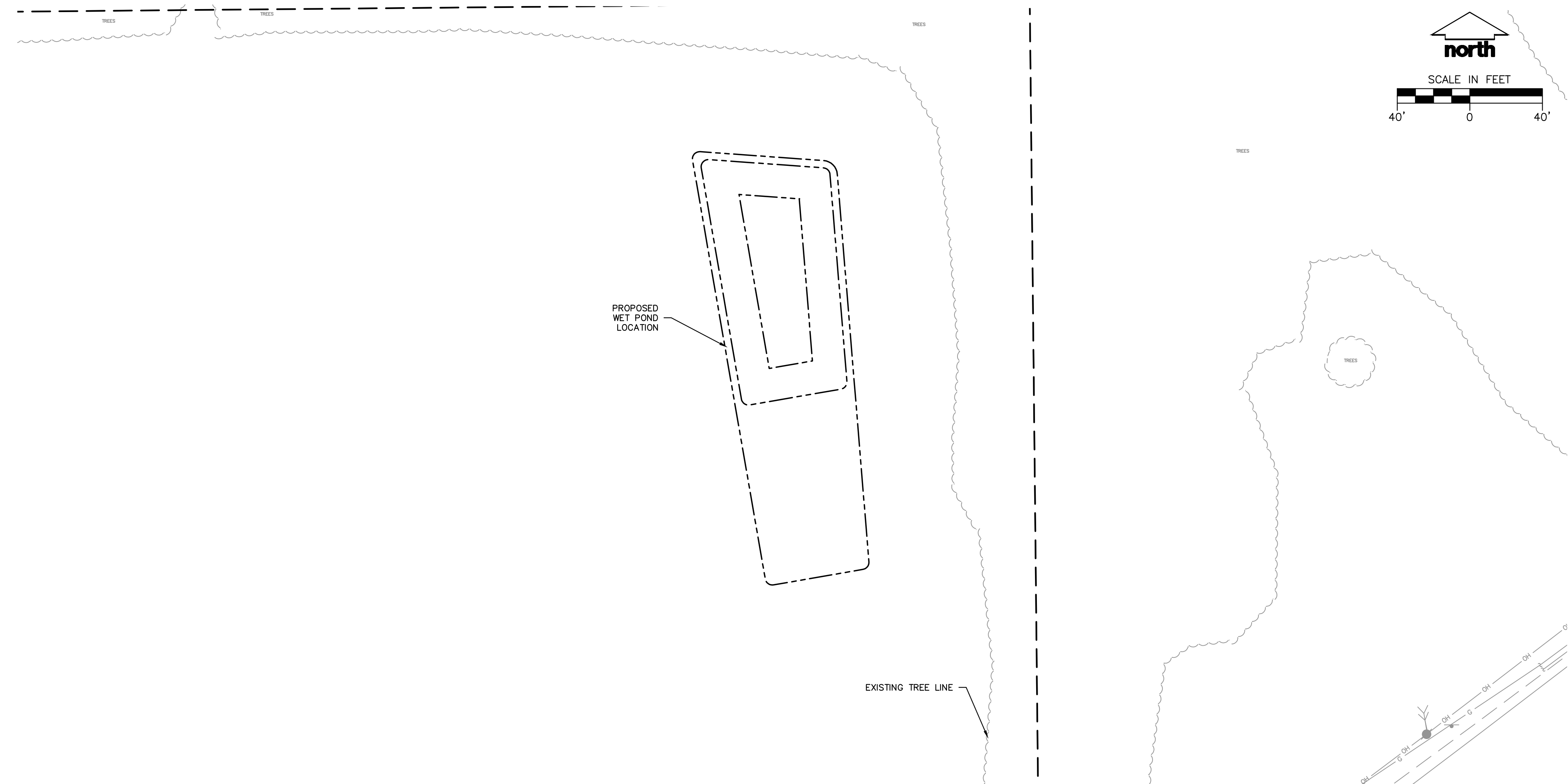

CREATE THE VISION TELL THE STORY

MADISON | MILWAUKEE | WAUSAU  
 APPLETON | KENOSHA | CHICAGO  
 COEUR D'ALENE

**MILWAUKEE REGIONAL OFFICE**  
 W238 N1610 BUSSE ROAD, SUITE 100  
 WAUKESHA, WISCONSIN 53188  
 P. 262.513.0666

CLIENT:  
**KAHLE BUILDERS**

CLIENT ADDRESS:  
**15171 W. NATIONAL AVE.  
 NEW BERLIN, WI 53151**

PROJECT:  
**ETHIC INDOOR  
 SPORTS FACILITY**

PROJECT LOCATION:  
**5330 S. RACINE AVE.  
 NEW BERLIN, WI**

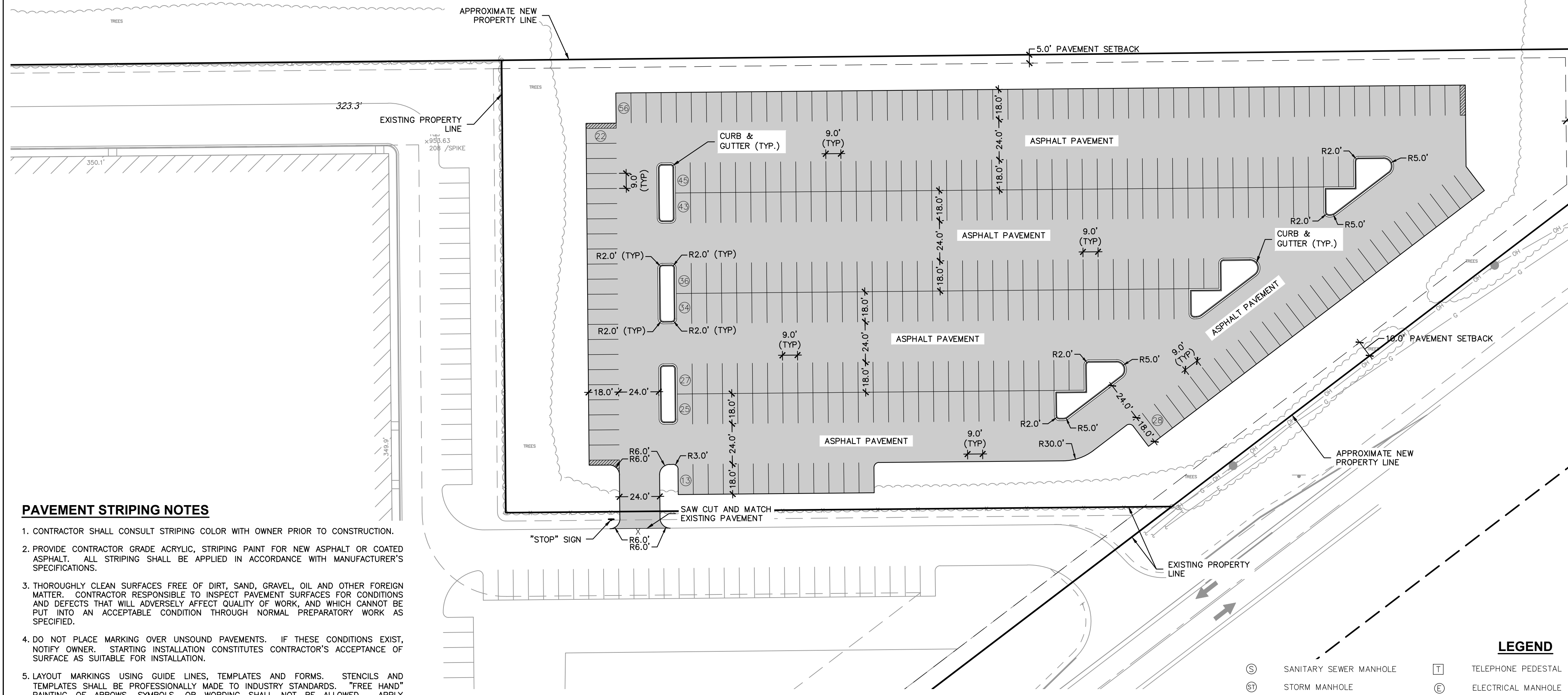

PARKING COUNT:	
329	NEW PARKING STALLS
662	PARKING STALLS TOTAL
4	CURRENTLY ADA ACCESSIBLE STALLS
4	CURRENTLY VAN ACCESSIBLE STALLS
6	NEW ADA ACCESSIBLE STALLS REQUIRED

**PAVEMENT THICKNESS NOTE**

ALL PAVING SHALL CONFORM TO "STATE OF WISCONSIN STANDARD SPECIFICATIONS FOR HIGHWAY & STRUCTURE CONSTRUCTION - CURRENT EDITION AND ADDENDUM, AND APPLICABLE CITY OF NEW BERLIN ORDINANCES.

\*\* FINAL PAVEMENT DESIGN TO BE DETERMINED BY OWNER BASED ON GEOTECHNICAL ENGINEER OF RECORD RECOMMENDATIONS. ALL PAVING SHALL BE PERFORMED IN ACCORDANCE WITH THE GEOTECHNICAL ENGINEER OF RECORDS RECOMMENDATIONS AS SPECIFIED IN THE SAID GEOTECHNICAL REPORT.

**MINIMUM PAVEMENT STRUCTURE**

- LIGHT DUTY ASPHALT PAVEMENT
  - 3-1/2" ASPHALTIC CONCRETE (2 LIFTS, 2" BINDER, 1-1/2" SURFACE)
  - LOWER LAYER (3 MT 58-28 S)
  - UPPER LAYER (5 MT 58-28 S)
- 8" CRUSHED AGGREGATE BASE COURSE (1-1/4" DENSE GRADED LIMESTONE)
- CLEAN RECYCLED CRUSHED CONCRETE MAY BE USE IF APPROVED BY GEOTECH ENGINEER OF RECORD.
- CONCRETE SIDEWALK AND STOOPS
  - 4" CONCRETE
  - 6" CRUSHED AGGREGATE BASE COURSE
  - CLEAN RECYCLED CRUSHED CONCRETE MAY BE USE IF APPROVED BY GEOTECH ENGINEER OF RECORD.

**PAVEMENT STRIPING NOTES**

- CONTRACTOR SHALL CONSULT STRIPING COLOR WITH OWNER PRIOR TO CONSTRUCTION.
- PROVIDE CONTRACTOR GRADE ACRYLIC, STRIPING PAINT FOR NEW ASPHALT OR COATED ASPHALT. ALL STRIPING SHALL BE APPLIED IN ACCORDANCE WITH MANUFACTURER'S SPECIFICATIONS.
- THOROUGHLY CLEAN SURFACES FREE OF DIRT, SAND, GRAVEL, OIL AND OTHER FOREIGN MATTER. CONTRACTOR RESPONSIBLE TO INSPECT PAVEMENT SURFACES FOR CONDITIONS AND DEFECTS THAT WILL ADVERSELY AFFECT QUALITY OF WORK, AND WHICH CANNOT BE PUT INTO AN ACCEPTABLE CONDITION THROUGH NORMAL PREPARATORY WORK AS SPECIFIED.
- DO NOT PLACE MARKING OVER UNSOUND PAVEMENTS. IF THESE CONDITIONS EXIST, NOTIFY OWNER. STARTING INSTALLATION CONSTITUTES CONTRACTOR'S ACCEPTANCE OF SURFACE AS SUITABLE FOR INSTALLATION.
- LAYOUT MARKINGS USING GUIDE LINES, TEMPLATES AND FORMS. STENCILS AND TEMPLATES SHALL BE PROFESSIONALLY MADE TO INDUSTRY STANDARDS. "FREE HAND" PAINTING OF ARROWS, SYMBOLS, OR WORDING SHALL NOT BE ALLOWED. APPLY STRIPES STRAIGHT AND EVEN.
- PROTECT ADJACENT CURBS, WALKS, FENCES, AND OTHER ITEMS FROM RECEIVING PAINT.
- APPLY MARKING PAINT AT A RATE OF ONE (1) GALLON PER THREE TO FOUR HUNDRED (300-400) LINEAL FEET OF FOUR (4) INCH WIDE STRIPES. (OR TO MFG. SPECIFICATION)
- BARRICADE MARKED AREAS DURING INSTALLATION AND UNTIL THE MARKING PAINT IS DRIED AND READY FOR TRAFFIC.
- ALL HANDICAPPED ACCESSIBLE PARKING SHALL BE LOCATED PER 2009 IBC 1106.6

**LEGEND**

- |   |                        |     |                    |       |                          |
|---|------------------------|-----|--------------------|-------|--------------------------|
| ⊕ | SANITARY SEWER MANHOLE | ⊠   | TELEPHONE PEDESTAL | —ST—  | STORM SEWER              |
| ⊙ | STORM MANHOLE          | ⊚   | ELECTRICAL MANHOLE | —G—   | UNDERGROUND GAS          |
| ⊕ | CATCH BASIN ROUND      | ⊞   | SIGN               | —E—   | UNDERGROUND ELECTRIC     |
| ⊕ | CATCH BASIN SQUARE     | ⊞   | POWER POLE         | —T—   | UNDERGROUND TELEPHONE    |
| ⊕ | FIRE HYDRANT           | ⊞   | GUY WIRE           | —FIB— | UNDERGROUND FIBER OPTICS |
| ⊕ | WATER VALVE            | —X— | FENCE LINE         | —OH—  | OVERHEAD UTILITY         |
| ⊕ | GAS VALVE              | —S— | SANITARY SEWER     | ⊙     | CONIFEROUS TREE          |
| ⊕ | LIGHT POLE             | —W— | WATER MAIN         | ⊙     | DECIDUOUS TREE           |

**PLAN MODIFICATIONS:**

#	Date:	Description:
1	04.05.2022	CITY SUBMITTAL
2	04.19.2022	OWNER REVIEW
3		
4		
5		
6		
7		
8		
9		
10		
11		
12		
13		
14		
15		

Design/Drawn: YT/JJS  
 Approved: TJB

**SHEET TITLE:  
 DIMENSION AND  
 PAVEMENT ID PLAN**

SHEET NUMBER:  
**C1.0**

